

# Churchlands Road

BEDMINSTER

APPROXIMATE FLOOR AREA  
103.4 SQM / 1113 SQFT



GROUND FLOOR  
571 sq.ft. (53.0 sq.m.) approx.

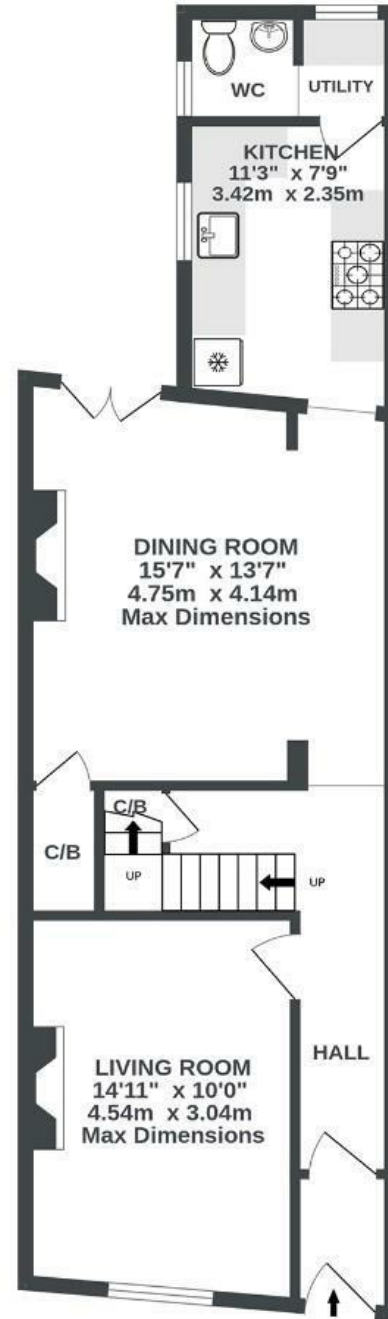

1ST FLOOR  
542 sq.ft. (50.3 sq.m.) approx.

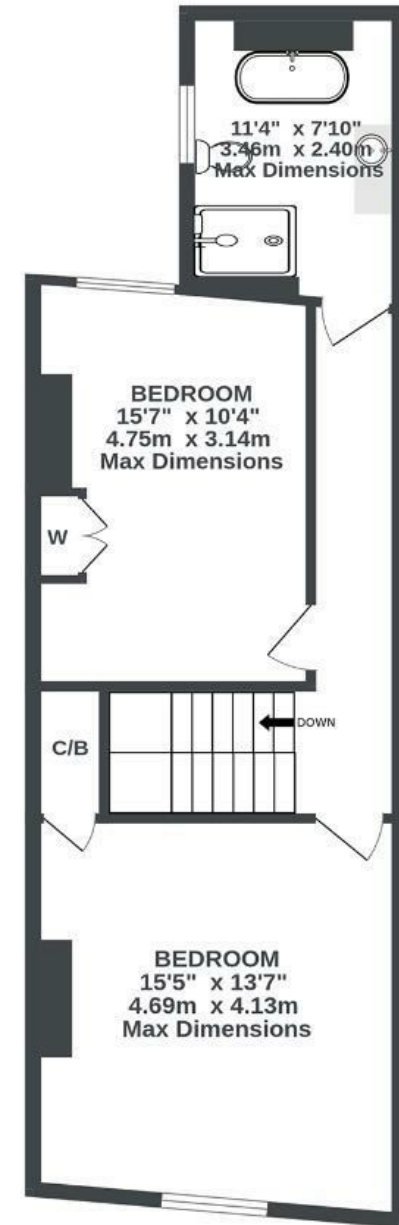

Illustrations are for reference purposes only, measurements are approximate, not to scale.

Boardwalk

# Churchlands

BEDMINSTER, BRISTOL

£

£425,000

zZz

2 Bedrooms



BS3 3PW



1 Bathrooms

*"The community on Churchlands Road is fantastic and was such a pleasant surprise when we first moved in. All of the neighbours are friendly and supportive and really come together to make a lovely environment. We regularly get together, whether for drinks at each others' houses at Christmas or for BBQs in the summer. There is even a community garden at the end of the street that people volunteer to maintain, including a nature pond teeming with frogs. We've made real friends on the road."*

